

Proposed extent of new Zone F Residents Parking Scheme

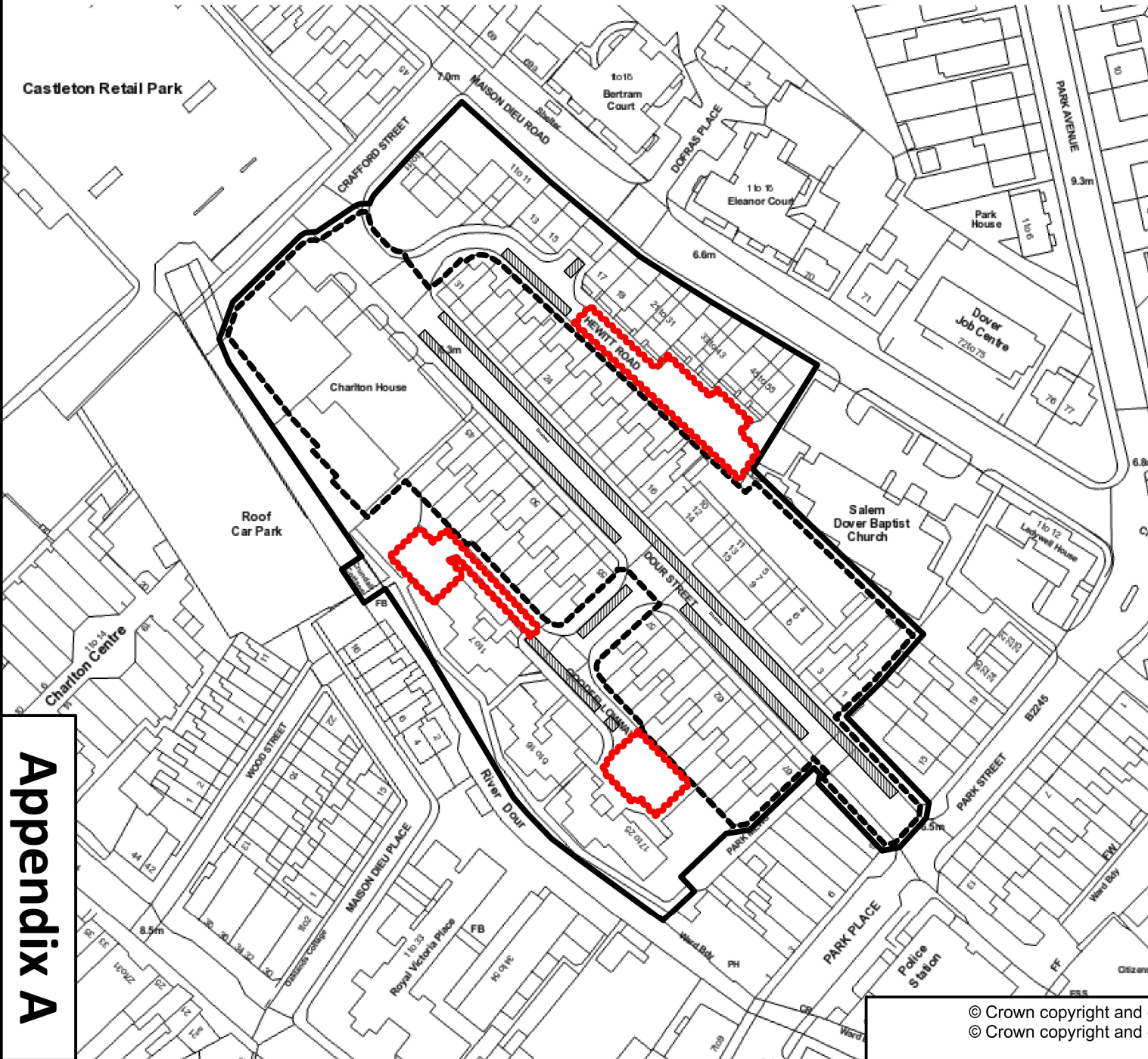

KEY FOR MAP:



Existing extent of Zone F Residents Parking Scheme (Dour Street only).



Proposed enlarged Zone F Residents Parking Scheme, to include Dour Street, Hewitt Road and Goodfellow Way.

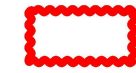

Private parking for Hewitt Road & Goodfellow Way residents.



Extent of Parking Bays, including existing Disabled bays.

Double Yellow Lines (Prohibition of Parking) to cover all other sections of roads within the zone.

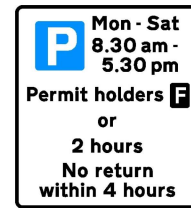

Proposed restriction, as shown on sign. Posts with signs required on the footpath adjacent to white marked parking places.

Scale: 1:1000 Date: January 2021 Drawn by: DA



Prepared By:
Operations & Commercial Division
Eurling Roger Walton, C. Eng. M. I. C. E
Strategic Director
Dover District Council
Honeywood Close
White Cliffs Business Park
Whitfield
DOVER
CT16 3PJ

